

New Harry Kizirian School

AGENDA

Programming

Schematic Design Review

Next Steps

Questions & Answers



Providence
Schools



DOWNES
ARCHITECTS



STUDIO JAED



RIDE
Rhode Island
Department
of Education

Programming

PK-8, 3 Track, 729 Students .

Approx. 78,000 sq.ft.

Schematic Design Review



Camden Ave. Main Entrance



Danforth St. Entrance



Pre K & K Play Areas Along Camden Ave



- Kitchen, Cafeteria, Stage
- Music
- Pre K
- Fitness
- Nurse & Guidance
- Science
- Art, CTE/STEM

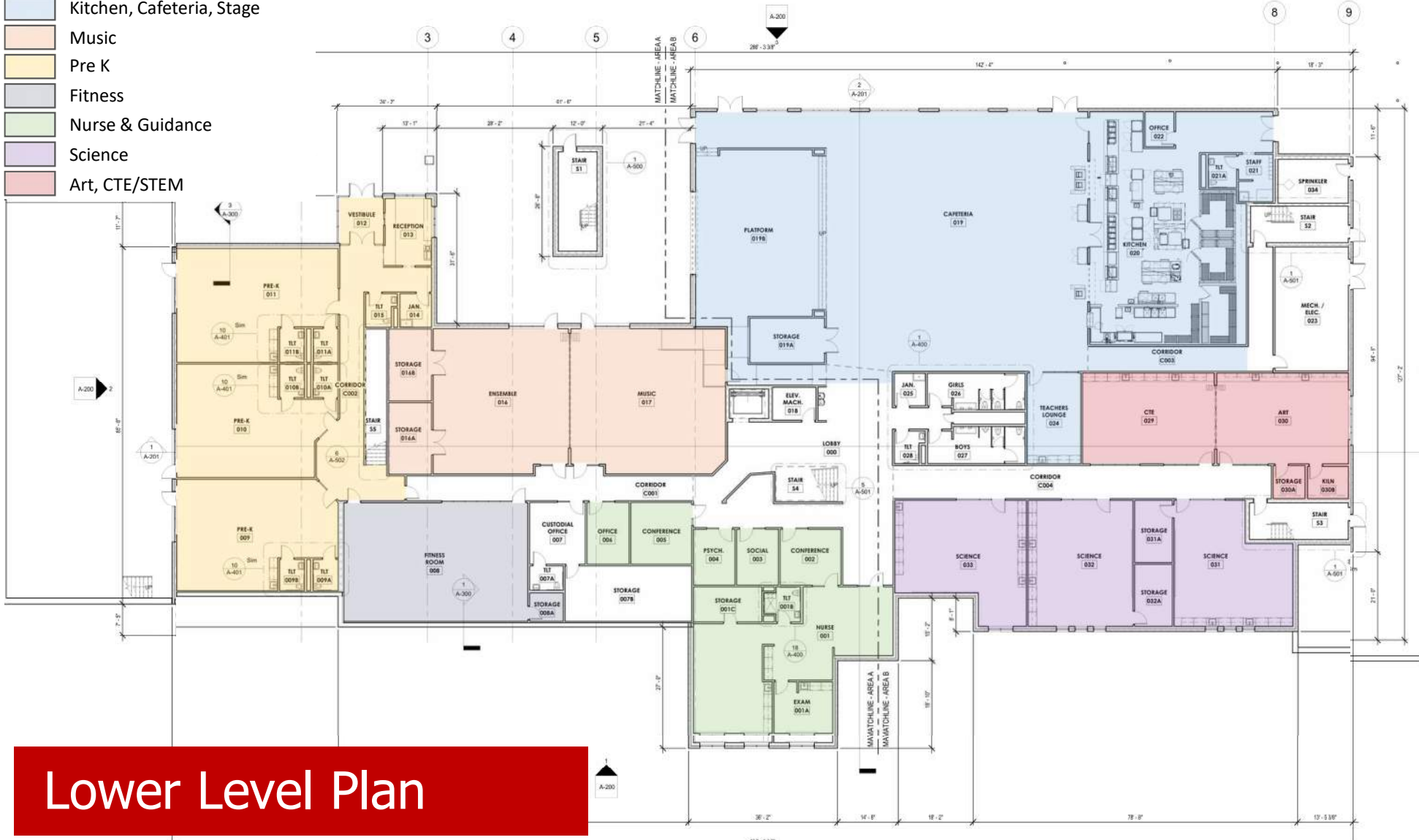

Lower Level Plan

- Entrance & Administration
- Special Education
- Facilitator Suite
- K thru 2nd Grade
- 6th thru 8th Grade
- Media Center
- Resource Rooms



Main Level Plan

- Science/Art - STEM
- Special Education
- Facilitator Suite
- 3rd thru 5th Grade
- Media Center
- Resource Rooms



Upper Level Plan

Secure Vestibule

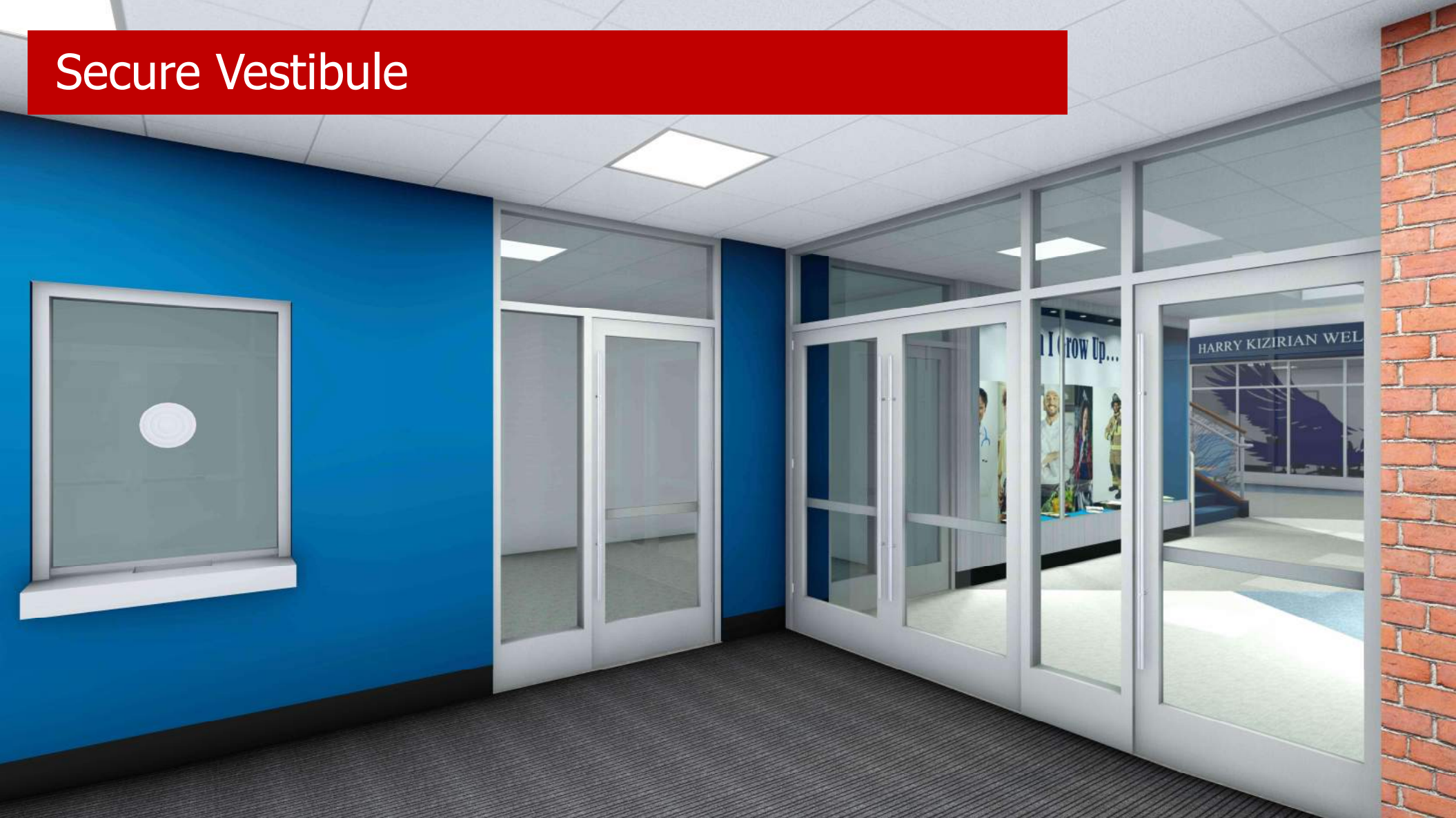

Main Level Lobby

School



Harry Kizirian

a Providence native, is one of the nation's most decorated World War II servicemen for his actions in combat in the Pacific Theater.

He graduated Mount Pleasant High School on February 22, 1944, where he was recognized as the most outstanding athlete of his class.

Kizirian enlisted in the Marine Corps on Feb. 23, 1944 and was sent overseas on October 6, 1944

While on Okinawa in May 1945, facing enemy machine gun fire that had pinned down his platoon, Kizirian fearlessly charged the enemy position, freeing the trapped Americans. The following month, though already wounded three times, Kizirian engaged and eliminated an enemy force that had surrounded a team of American troops evacuating wounded soldiers.

Kizirian entered the U.S. Postal Service after his discharge from the Marine Corps on Feb. 11, 1946. Ultimately, he would serve as the postmaster for the City of Providence. In recognition of his continued outstanding service, Rhode Island's main post office was renamed the Harry Kizirian Post Office.



Okinawa: The Costliest Battle in the Pacific War

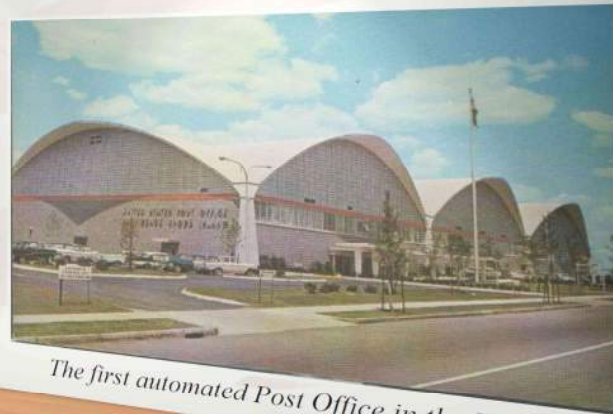

The first automated Post Office in the World

Main Level Lobby

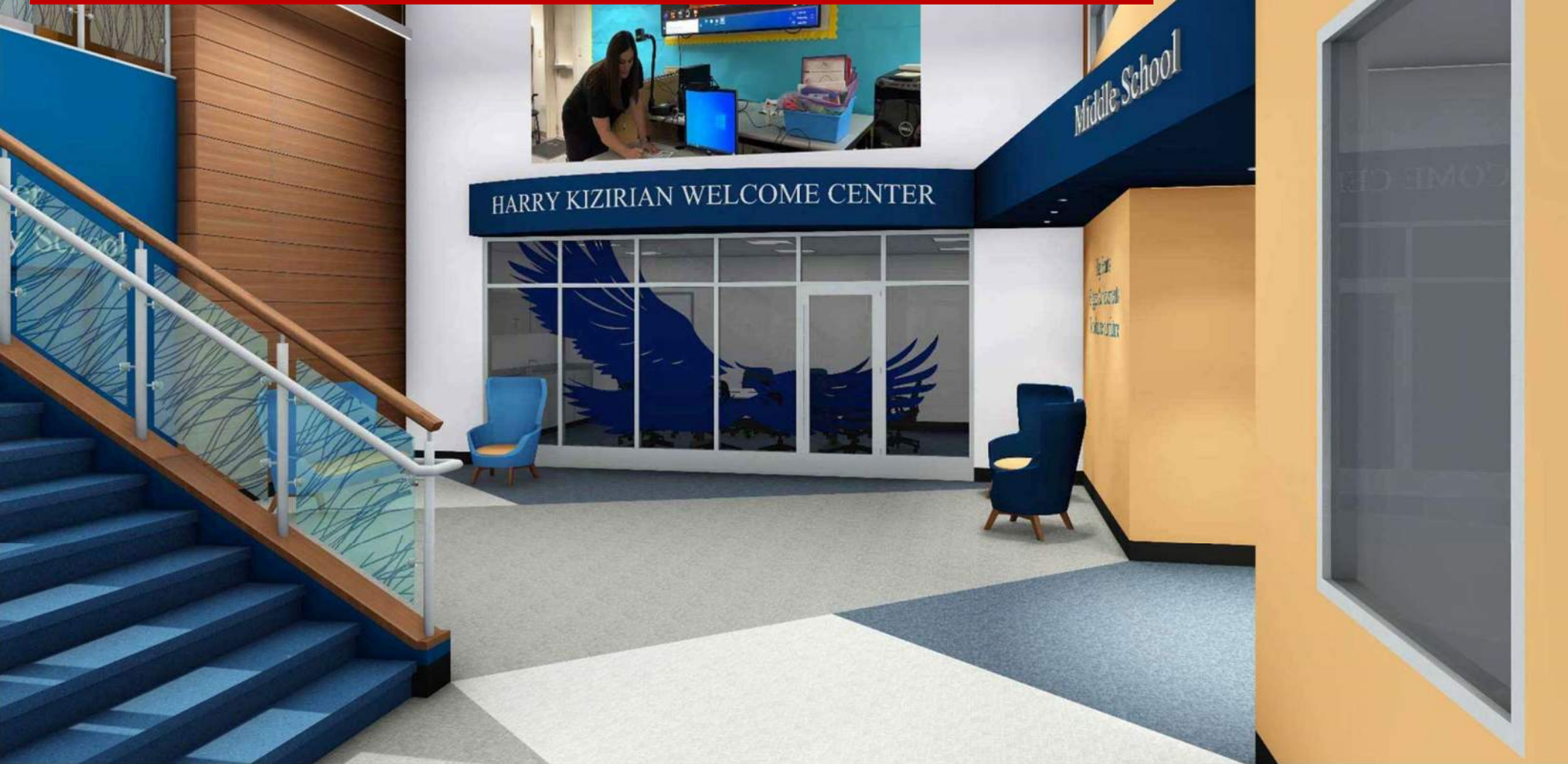

Main Level Lobby



Lower
Elementary School

Main Level Lobby

KIZIRIAN WELCOME CENTER

Middle School

Big Hearts
Bigger Achievements
To educate our future



Upper Lobby



Upper Lobby



Media Center



Media Center



Resource Rooms



Connection to Rogers Rec. & Pool



Next Steps

Design & Documentation thru Spring 2024

Anticipated Construction Start Summer 2024

Questions & Answers